

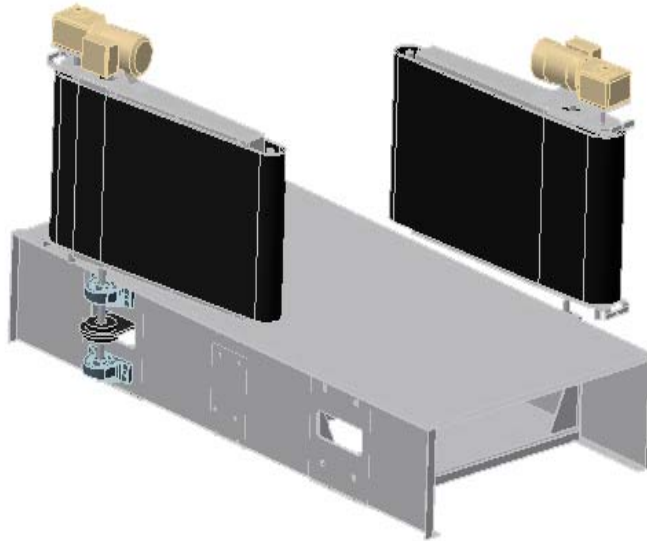

## The Horsley Company Baggage Handling Conveyor Equipment

### Specification: High Speed Diverter



#### **DESCRIPTION**

The Horsley Company High Speed Diverter is designed to divert baggage from a main line conveyor at chutes or conveyors oriented at an angle from the main line conveyor. Divert chutes or conveyors can be oriented up to a 90 degree angle from the main line conveyor. Unit is capable of diverting baggage at a rate of 60 bags per minute.

The unit consists of a 84" long horizontal bed section, two pivoting arms with vertical power face conveyors and an actuator mechanism. From the top of the conveyor, the bed pan is removable for ease of maintenance. The arms are positioned using an actuator mechanism mounted under the bed pan between the bed frames. The actuator is designed to provide a smooth divert motion and prevent arm motion over run. The arms are positioned parallel to the conveyor when baggage is not to be diverted and rotated across the conveyor to a 45 degree angle when baggage is diverted. The powered conveyor on the face of the vertical arm will run when the arm is in the divert position thus causing the baggage to divert and remain in approximately the same orientation as it was on the main line conveyor.

Control of the diverter is accomplished using an Allen-Bradley plc and three Allen-Bradley PowerFlex Variable Frequency Drives. One drive controls the actuator mechanism and the other two control the vertical power face belts. Use of the variable frequency drives ensures smooth operation and reduces mechanical wear to the unit. Proximity sensors are used to sense the position of the divert arm.



# The Horsley Company Baggage Handling Conveyor Equipment

## Specification: High Speed Diverter

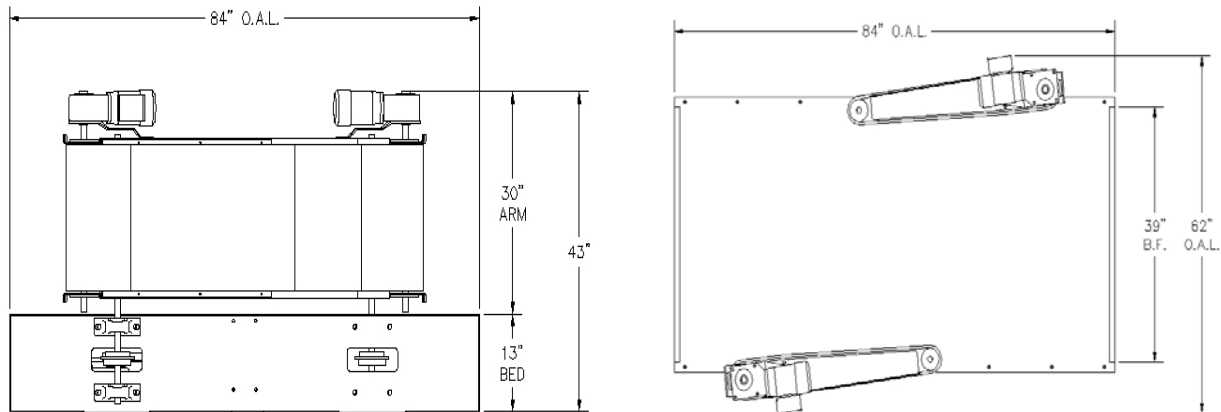

### FEATURES

**Length:**

- 84"

**Standard Width:**

- 39" between frames

**Vertical Belt Height:**

- 21"

**Side Clearance Required:**

- 11"

**Overall Height:**

- 45"

**Material:**

- 10 gauge hot-rolled steel bed frame and pan
- Modular Plastic Belting

**Bearings:**

- Precision 2-bolt flange bearings with eccentric locking-collars
- Precision 2-bolt pillow block bearings with eccentric locking-collars

**Capacity:**

- 60 Bags/Minute

**Power Requirements:**

- 480VAC, 3 Phase, 6 Amps

**Notes:**

- Right-hand and left-hand divert available.
- 2 return rolls included in bed.
- UL Listed Panel and Controls